



43 Meikle Inch Lane,  
Bathgate EH48 2UF  
Offers Over £133,000

**Caesar & Howie**  
*Solicitors & Estate Agents*



**43 Meikle Inch Lane**

**Bathgate EH48 2UF**

Early viewing is highly advised of this spacious and bright top/2nd floor flat in attractive setting with south facing private aspect to front. The well presented accommodation will make an excellent first buy and is in excellent order. Both bedrooms have generous size built-in wardrobes and it also benefits from secure attic space. Many extras can be available. Allocated parking and visitor parking is located to the side. Public transport, school, local amenities, supermarkets and rail station are all easily accessible. There is swift access for commuting via the A89 and M8. Flexible/early entry is available. Chain free.

- Communal entrance/entry phone
- Hallway
- Spacious bay window lounge/dining
- Fitted kitchen/breakfasting space
- Two double bedrooms (wardrobes)
- Bathroom /shower over bath
- GCH & DG
- South facing outlooks
- Allocated parking
- Factored grounds
- Council Tax Band C



**43 Meikle Inch Lane**

Viewings: Strictly by appointment through Caesar & Howie on 01506 435306 or email [mam@caesar-howie.co.uk](mailto:mam@caesar-howie.co.uk)



43 Meikle Inch Lane

## 43 Meikle Inch Lane

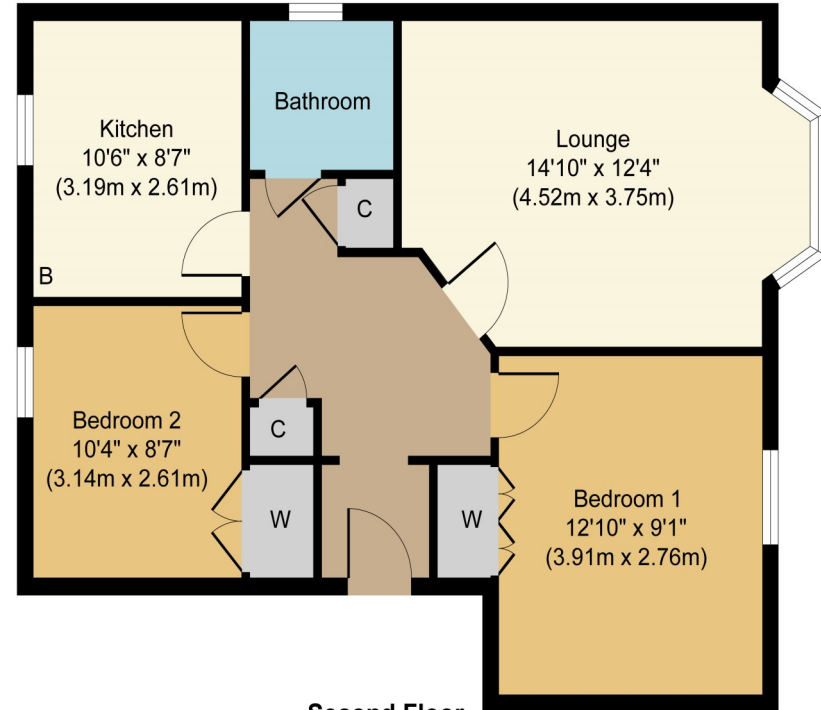

**Second Floor**  
**Approximate Floor Area**  
**691 sq. ft**  
**(64.22 sq. m)**

Whilst every attempt has been made to ensure the accuracy of the floor plan contained here, measurements of doors, windows, rooms and any other items are approximate and no responsibility is taken for any error, omission, or mis-statement. The measurements should not be relied upon for valuation, transaction and/or funding purposes. This plan is for illustrative purposes only and should be used as such by any prospective purchaser or tenant. The services, systems and appliances shown have not been tested and no guarantee as to their operability or efficiency can be given.

Copyright V360 Ltd 2025 | [www.houseviz.com](http://www.houseviz.com)